

# Indigo

Prefab House



**Prefab Log House**

## FITTINGS

## MODEL'S PICTURE

Solid pine wood  
(The specifications: 18mm  
21mm 28mm 36mm 50mm  
70mm 90mm 100mm  
120mm 140mm or thicker  
double panels)



Isolation material  
50mm 100mm  
Or thicker



Wooden door



Door locks



Metal Hinges



Wooden window



**FITTINGS****MODEL'S PICTURE**

Wooden shutter  
(MADE BY OURSELVES)



PVC window  
With screen window



Wooden floor  
(usually made of 18mm 21mm  
Pine wood)



Wooden roof  
(usually made of 18mm 21mm  
Pine wood)



Roof asphalt tiles



Screws and nails  
(used on roof )





Item no.:WIX-401139  
 Material:pine or spruce  
 Wall thickness:36mm  
 Size :6450\*4500mm  
 Total area:29sq.m.



Item no.:WIX-401146  
 Material:pine or spruce  
 Wall thickness:36mm  
 Size :5000\*5000mm  
 Total area:34sq.m.



Item no.:WIX-401140  
 Material:pine or spruce  
 Wall thickness:36mm  
 Size :4700\*4000mm  
 Total area:19sq.m.



Item no.:WIX-401158  
 Material:pine or spruce  
 Wall thickness:36mm,  
 Size :6500\*5680mm  
 Total area:37sq.m.



Item no.:WIX-401162  
 Material:pine or spruce  
 Wall thickness:36mm,  
 Size :5100\*3800mm  
 Total area:19.38sq.m.



Item no.:WIX-401145  
 Material:pine or spruce  
 Wall thickness:36mm  
 Size :5500\*5000mm  
 Total area:27.5sq.m.



Item no.:WIX-401138  
 Material:pine or spruce  
 Wall thickness:36mm,  
 Size :4995\*4000mm  
 Total area:20sq.m.



Item no.:XY-A-005  
 Material:pine or spruce  
 Wall thickness:36mm,  
 Size :5600\*4200mm  
 Total area:23.5sq.m.



Item no.:WIX-401172  
 Material:pine or spruce  
 Wall thickness:36mm  
 Size :8050\*7000mm  
 Total area:56.35sq.m.



\*The inside accessories are not included in our usual quotation



Item no.:XY-C-125  
 Material: spruce  
 Wall thickness:36mm  
 Size :7600\*6500mm  
 Total area:49.4sq.m.



Item no:WIX-402095  
 Material:pine or spruce  
 Wall thickness:70mm  
 Size :L11300\*W6800mm  
 Total area:88sq.m.



Item no:WIX-4020135  
 Material:pine or spruce  
 Wall thickness:70mm  
 Size :14300\*5750mm  
 Total area:83sq.m.





Item no: WIX-402095  
 Material: pine or spruce  
 Wall thickness: 70mm  
 Size :L11300\*W6800mm  
 Total area: 88sq.m.



Item no: WIX-402135  
 Material: pine or spruce  
 Wall thickness: 70mm  
 Size :14300\*5750mm  
 Total area: 83sq.m.



Item no: WIX-401192  
 Material: pine or spruce  
 Wall thickness: 70mm  
 Size :12600\*7800mm  
 Total area: 112sq.m.



Item no: WIX-402084  
 Material: pine or spruce  
 Wall thickness: 70mm  
 Size :12000\*W8000mm  
 Total area: 102sq.m.





Item no: WIX-4020157  
 Material: pine or spruce  
 Wall thickness: 70mm  
 Size :10300\*8700mm  
 Total area:103sq.m.

Item no: WIX-4020158  
 Material: pine or spruce  
 Wall thickness: 70mm  
 Size :10300\*8700mm  
 Total area:118sq.m.

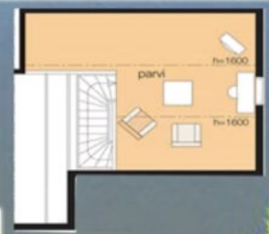

17.





Item no: WIX-4020150  
 Material: pine or spruce  
 Wall thickness: 70mm  
 Size : L14600\*W8400mm  
 Total area: 125.2sq.m.



Item no: WIX-402053  
 Material: pine or spruce  
 Wall thickness: 70mm  
 Size : 11000\*7900mm  
 Total area: 124sq.m.



Item no: WIX-402075  
 Material: pine or spruce  
 Wall thickness: 70mm  
 Size : 12100\*11500mm  
 Total area: 218sq.m.



Item no: WIX-402087  
 Material: pine or spruce  
 Wall thickness: 70mm  
 Size : 10800\*9900mm  
 Total area: 146sq.m.







Item no: WIX-4020139  
 Material: pine or spruce  
 Wall thickness: 70mm  
 Size :13500\*8800mm  
 Total area:167sq.m.

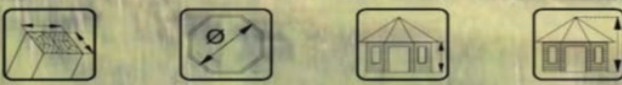

Item no: WIX-402130  
 Material: pine or spruce  
 Wall thickness: 70mm  
 Size :12100\*8800mm  
 Total area:178.5sq.m.

120x120 mm      465 cm      207 cm      346 cm

Item no: XY-TZ-02  
 Material :Pine or spruce  
 Size :(D)4650\*(H)3460mm

